

# TH

## Tissue Homogenizer

### User Manual

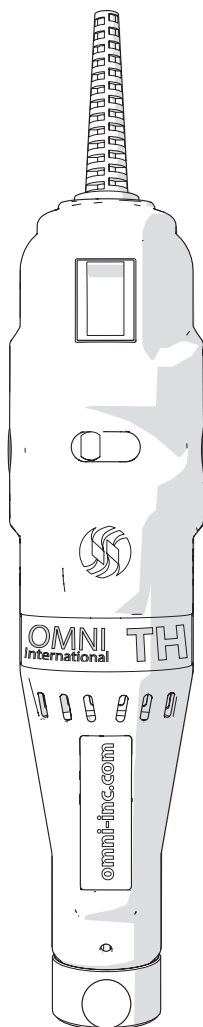

Data herein has been verified and validated. It is believed adequate for the intended use of the instrument. If the instrument or procedures are used for purposes over and above the capabilities specified herein, confirmation of the validity and suitability should be obtained; otherwise Omni International does not guarantee results and assumes no obligation or liability. This publication is not a license to operate under, or a recommendation to infringe upon, any process patents.

This product is warranted to be free from defects in material and workmanship for a period of ONE YEAR from the date of delivery. Omni International will repair or replace and return free of charge any part which is returned to its factory within said period, transportation prepaid by user, and which is found upon inspection to have been defective in materials or workmanship. This warranty does not include normal wear from use; it does not apply to any instrument or parts which have been altered by anyone other than an employee of Omni International nor to any instrument which has been damaged through accident, negligence, failure to follow operating instructions, the use of electric currents or circuits other than those specified on the plate affixed to the instrument, misuse, or abuse. Omni International reserves the right to change, alter, modify, or improve any of its instruments without any obligation whatever to make corresponding changes to any instrument previously sold or shipped.

THE FORGOING OBLIGATION IS IN LIEU OF ALL OBLIGATIONS AND LIABILITIES INCLUDING NEGLIGENCE AND ALL WARRANTIES OF MERCHANTABILITY OR OTHERWISE, EXPRESSED OR IMPLIED IN FACT OR BY LAW, AND STATE OUR ENTIRE AND EXCLUSIVE LIABILITY AND BUYERS EXCLUSIVE REMEDY FOR ANY CLAIM OF DAMAGES IN CONNECTION WITH THE SALE OR FURNISHING OF GOODS OR PARTS, THEIR DESIGN, SUITABILITY FOR USE, INSTALLATION, OR OPERATION. Omni International WILL IN NO EVENT BE LIABLE FOR ANY SPECIAL OR CONSEQUENTIAL DAMAGES WHATSOEVER, AND THEIR LIABILITY UNDER NO CIRCUMSTANCES WILL EXCEED THE CONTRACT PRICE FOR THE GOODS FOR WHICH LIABILITY IS CLAIMED.

This product has been engineered for safety; however, basic safety precautions and common sense must always be demonstrated when using any electrical product.

- DO NOT attempt to modify any part of this product.
- DO NOT allow the machine to be submerged in any liquid.
- DO NOT use in any setting other than an indoor laboratory.
- DO NOT plug power cord into an incorrect outlet or subject it to an incorrect voltage.
- Use this product only for its intended purpose.
- DO NOT use attachments not recommended by the manufacturer.
- DO NOT operate the product if it is damaged in any way.
- Keep this product away from heated surfaces.
- DO NOT modify the plug or cord that is provided. If the plug will not fit the outlet, have the proper outlet installed by a qualified electrician.
- DO NOT operate the product with the safety ground disconnected.

**WARNING:** Reduce the risk of unintentional starting; make sure the speed switch is in the OFF position before plugging in the motor.

**WARNING:** Damaged or worn power cords should be repaired or replaced immediately by a qualified electrician.

**WARNING:** Improper connection of the equipment can result in a risk of electric shock.

# Overview

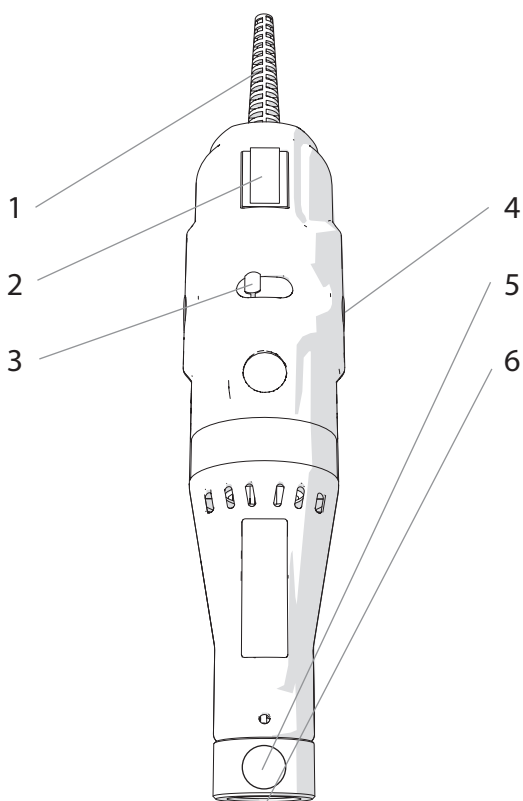

- 1. Power Cord
- 2. On/Off Switch
- 3. Speed Control
- 4. Motor Brushes
- 5. Thumb Screw
- 6. Probe Coupling

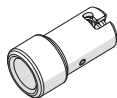

Adapter  
12-120

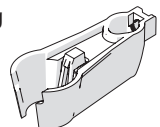

Clamp  
12-118

The Omni TH consists of the following:

Description	Quantity
Motor Drive Unit (110V)	1
Or Motor Drive Unit (220V)	
Clamp	1
Tool Kit	1
Soft Tissue Omni Tip	1
Hard Tissue Omni Tip	1
Omni Tip Adapter	1
Instruction Manual	1

Optional Stand Available (sold separately) - Order No. S1000

# Stand Mounting

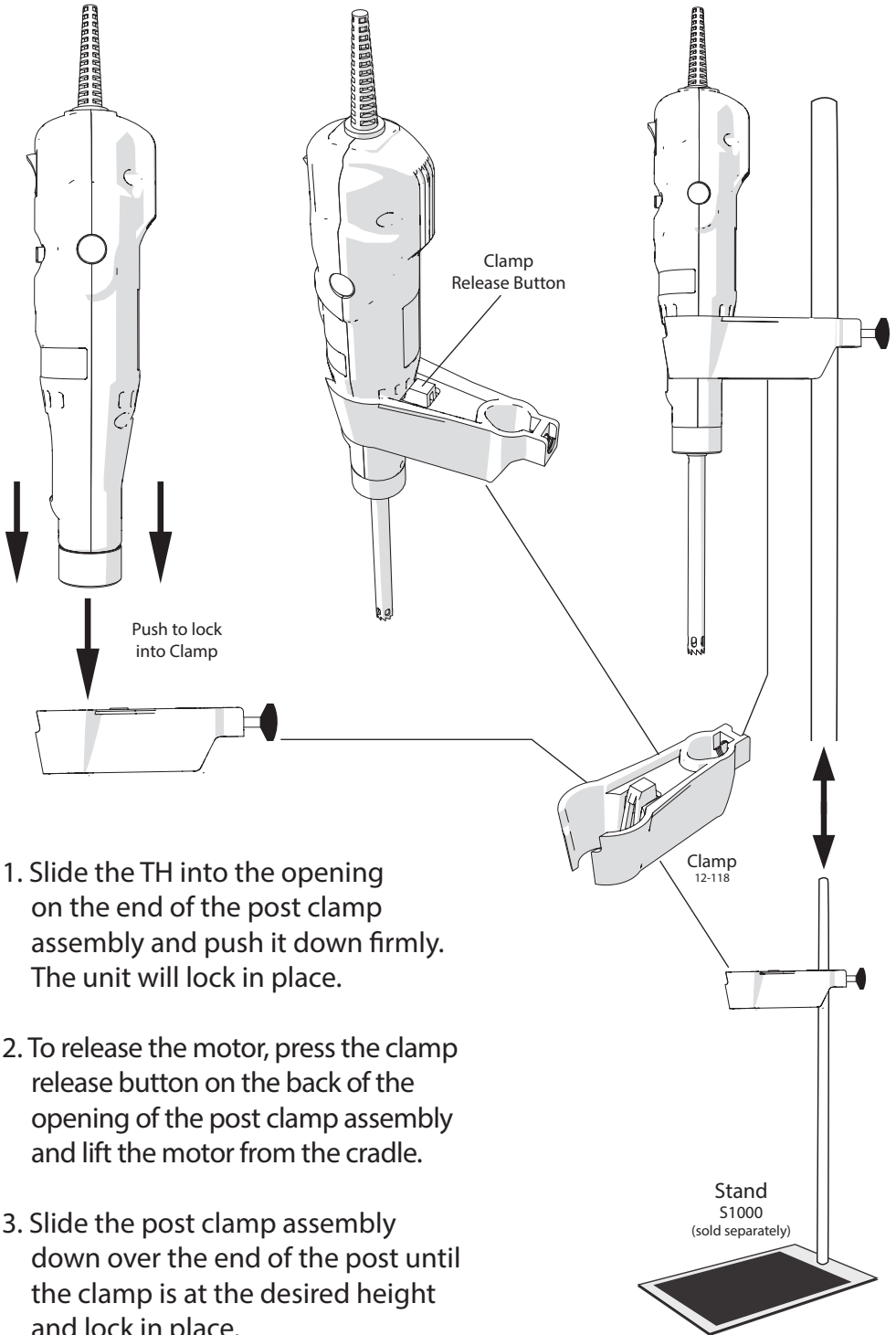

# Accessories

## Generator Probes

1. Insert Generator Probe into coupling

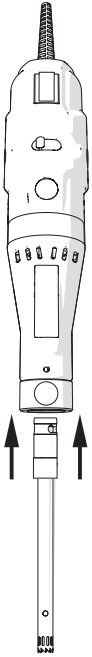

2. Quarter turn clockwise to lock

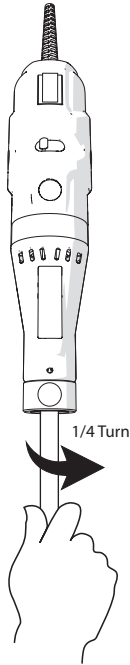

3. Tighten Thumbscrew

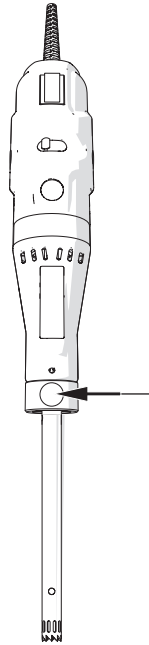

4. Ready to use  
\*always submerge probe in liquid before starting

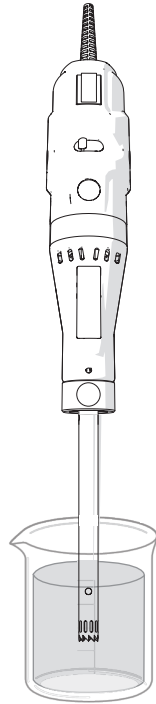

\*Never run dry

## Omni Tips™ and Adapter

1. Insert Adapter into coupling

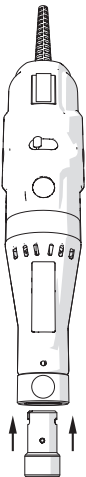

2. Quarter turn clockwise. Tighten Thumbscrew

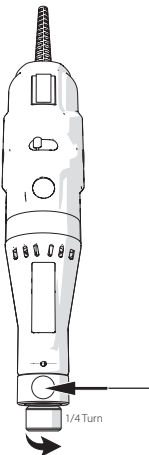

3. Insert Omni Tip™ into adapter

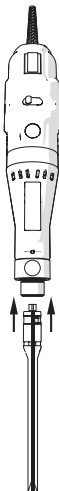

4. Quarter turn clockwise to lock

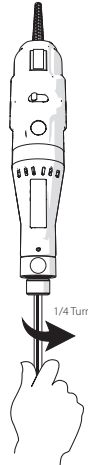

5. Ready to use  
\*always submerge probe in liquid before starting

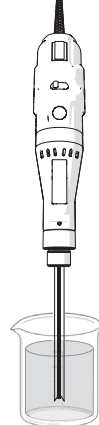

\*Never run dry

# Stainless Steel Generator Probes

Size	Processing Range	Type	Order No.
5 mm	.020 mL - 5 mL	Flat Bottom	G5-75
		Flat Bottom - Wide Window	G5-75W
7 mm	.25 mL - 30 mL	Flat Bottom	G7-95
		Flat Bottom - Wide Window	G7-95W
		Saw Tooth	G7-115ST
		Saw Tooth - Wide Window	G7-115STW
10 mm	1.5 mL - 100 mL	Saw Tooth	G10-115ST
		Saw Tooth - Wide Window	G10-115STW

Omni Tips®

Plastic  
Disposable  
Generator  
Probes

Type	Size	Quantity	Order No.
Hard Tissue	7 mm x 110 mm	25 Pack	30750H
	7 mm x 110 mm	50 Pack	32750H
Soft Tissue	7 mm x 110 mm	25 Pack	30750
	7 mm x 110 mm	50 Pack	32750
	<b>Adapter</b>	1	12-120

(required for plastic probes)

## Operation

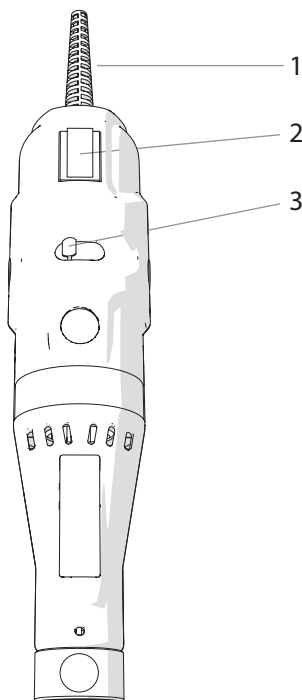

1. Power Cord
2. On/Off switch
3. Speed Control

## General Operation

### Power

- Plug in the power cord

### Start

- Move the On/Off switch on the front of the unit to the On position.

### Set Speed

- Adjust speed using the speed control.  
To increase rpm, move control from left to right.

### Stop

- Move the On/Off switch to the Off position.

# Troubleshooting

PROBLEM	CORRECTIVE ACTION
The Omni TH is plugged in and turned on but is not functioning.	<ul style="list-style-type: none"><li>- Check power cord connectors</li><li>- Check wall socket for power to the outlet</li></ul>
Motor is turned ON and makes a makes a “buzzing” sound, but is not working.	<ul style="list-style-type: none"><li>- Check that the brushes are not worn and are correctly installed.</li></ul>
Motor unit operating speed declines, stalls intermittently, or stops completely	<ul style="list-style-type: none"><li>- Check that the brushes are not worn and are correctly installed.</li></ul>
PTFE bearing wears quickly	<ul style="list-style-type: none"><li>- Fluid level may be too low in the tube.</li><li>- Immerse the probe deeper into the fluid.</li></ul>



**OMNI**  
International

Omni International, Inc.  
935C Cobb Place Blvd.  
Kennesaw, GA 30144  
800.776.4431 • 770.421.0058  
[www.omni-inc.com](http://www.omni-inc.com)